



STARHOTELS®

# Michelangelo

FIRENZE

**S**umptuous style meets Florentine glamour. Exuding all the allure of this timeless city, the recently refurbished Michelangelo pairs classic design with thoughtful, contemporary touches. Moments away you'll discover the glittering River Arno, glimpse the famous Ponte Vecchio and follow its call to the heart of the city. Inside, we're set up to host events on a suitably grand scale with facilities for up to 230 people, complemented by the calm, chic surroundings of the newly refurbished bar and restaurant.

Viale Fratelli Rosselli, 2  
50123 Firenze - ITALY  
T +39 055 27841  
F +39 055 2382232  
[michelangelo.fi@starhotels.it](mailto:michelangelo.fi@starhotels.it)  
[starhotels.com](http://starhotels.com)



### **Rooms & Suites**

Our 119 rooms and suites are styled in subtle tones with a choice of contemporary or traditional detailing to provide a comfortable oasis.

### **Restaurant & bar**

From dining in the style of a traditional Tuscan villa to classic cocktails in the trendsetting bar, we've something for every taste.

### **Services**

Specially selected to ensure an exceptional stay from garage to Wi-Fi, room service and expert local advice.

### **Meetings & Events**

Seven modern meeting rooms for up to 230 people, hi-tech facilities and an experienced team will help you deliver an event to remember.











## Location

Just steps from River Arno, the Michelangelo hotel is right at the historic heart of Florence, with the city's rich collection of artistic and architectural treasures all within easy reach. Conveniently located near to Florence's central train station, you're also a short walk from the famous Ponte Vecchio, with its glittering goldsmiths shops. Also nearby is the ornate Duomo, as well as many fabulous eateries from which to sample authentic Italian cuisine.



## From the station

- From Santa Maria Novella station, the Starhotels Michelangelo can be reached using the new tram service and getting off at the first stop "Porta al Prato", located 50 meters away.

## From the highway

- From Milan, Highway A1 exit on Firenze Nord, then direction Porta al Prato. From Rome. Highway A1, exit Firenze Scandicci, then direction City Center; after crossing Ponte alla Vittoria bridge, turn right and then turn left on Viale F.lli Rosselli.

## From the airport

- Take the "Volainbus", exit in Smn railway station, then take tram T1 till the 1st stop "Parco della musica - Stazione Leopolda".t



## 7 meeting rooms

All meeting rooms are equipped with: Wi-Fi (at a charge), sound system, screen, LCD projector<sup>(1)</sup>, flip chart, other services are available upon request.

<sup>(1)</sup>Max one LCD projector complimentary, additional requests at a charge



| Meeting rooms               | Area mq / ft.   | L x W mt. / ft.   | Height mt. / ft. | Theatre | Class room | Conference table/ U-shape | Cabaret style <sup>^</sup> | Cocktail reception | Banquet |
|-----------------------------|-----------------|---|------------------|---------|------------|---------------------------|----------------------------|--------------------|---------|
| Michelangelo <sup>°</sup>   | 206<br>2216,56  | 17,83x11,55<br>58,50x37,89                                | 2,7<br>8,86      | 230     | 90         | 50                        | 80                         | 230                | 170     |
| Leonardo (A) <sup>°</sup>   | 80<br>861,1     | 10,20x9,00<br>33,47x29,52                                 | 2,7<br>8,86      | 65      | 35         | 28                        | 60                         | 50                 | 35      |
| Leonardo (B) <sup>°</sup>   | 40<br>430,55    | 10,50x4,30<br>34,44x14,10                                 | 2,7<br>8,86      | 35      | 20         | 15                        | -                          | 20                 | 15      |
| Leonardo (A+B) <sup>°</sup> | 126<br>1355,76  | 14,00x9,00<br>45,93x29,53                                 | 2,7<br>8,86      | 100     | 55         | 38                        | -                          | 90                 | 80      |
| Brunelleschi                | 123<br>1323,48  | 14,50x8,50<br>47,57x27,89                                 | 2,4<br>7,87      | 100     | 50         | 35                        | 60                         | 90                 | 70      |
| Botticelli <sup>°</sup>     | 69<br>742,44    | 9,81x7,03<br>32,18x23,06                                  | 2,7<br>8,86      | 45      | 18         | 18                        | 35                         | 50                 | 40      |
| Masaccio <sup>°</sup>       | 66<br>710,16    | 11,10x5,30<br>36,42x17,39                                 | 2,7<br>8,86      | 40      | 18         | 18                        | 30                         | 50                 | 40      |
| Giotto <sup>°</sup>         | 32<br>344,32    | 5,50x5,70<br>18,04x18,70                                  | 2,7<br>8,86      | -       | -          | 8                         | -                          | -                  | -       |
| Assaggi Restaurant          | 238*<br>2560,88 | 9,50x17,80 +<br>9,80x8,00<br>31,00x58,00 +<br>32,00x26,00 | 2,2<br>7,22      | -       | -          | -                         | -                          | 320                | 220     |

<sup>°</sup> Daylight

<sup>^</sup> Cabaret style: Diameter tables cm 140, up to 5 pax each

\* Areas with irregular forms

STARHOTELS®

Michelangelo  
FIRENZE

Viale Fratelli Rosselli, 2  
50123 Firenze - ITALY  
T +39 055 27841 - F +39 055 2382232  
meeting.michelangelo.fi@starhotels.it starhotels.com

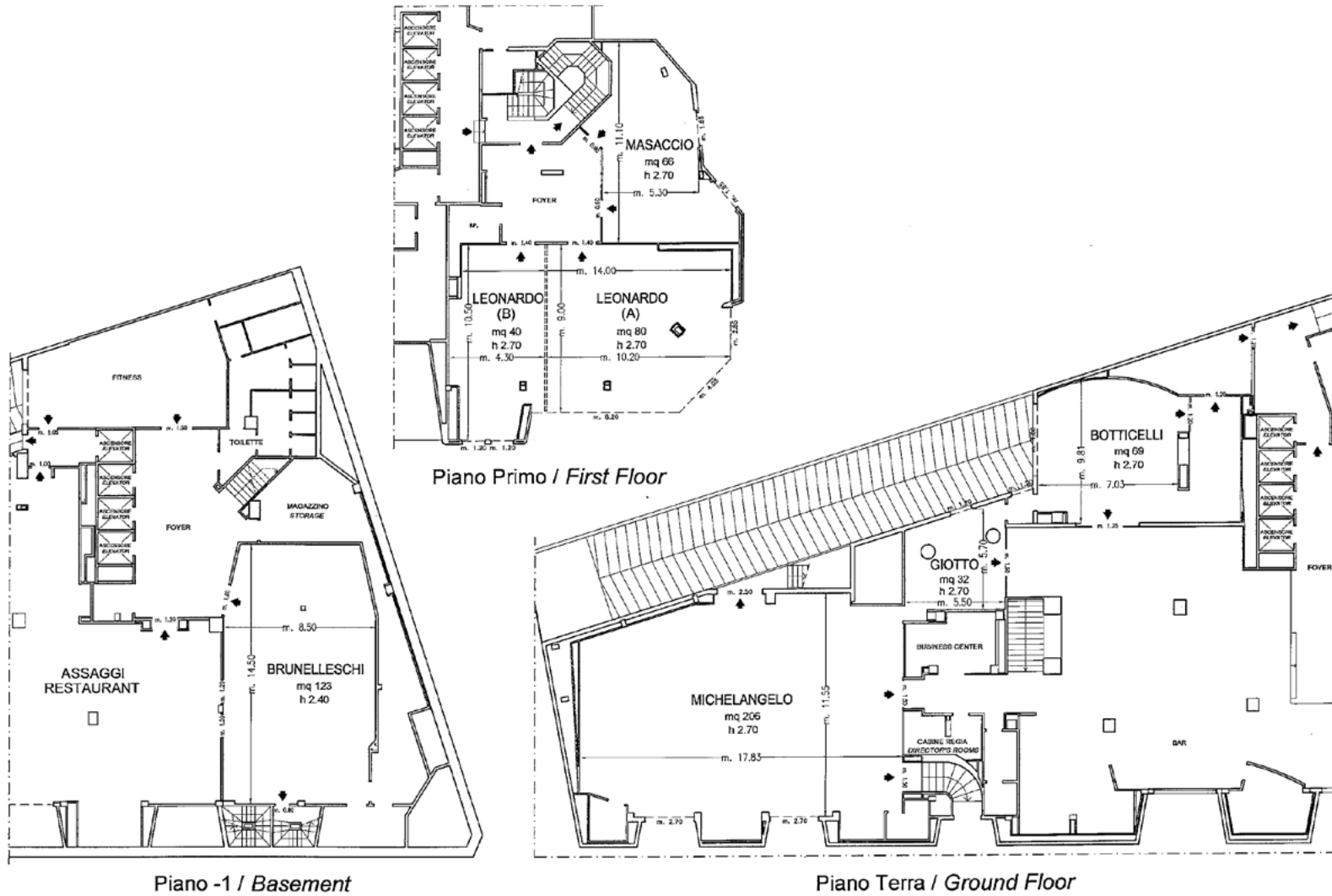

7 meeting room fino a 230 persone/ 7 meeting rooms up to 230 seats

STARHOTELS®

Michelangelo  
FIRENZE

Viale Fratelli Rosselli, 2  
50123 Firenze - ITALY  
T +39 055 27841 - F +39 055 2382232  
meeting.michelangelo.fi@starhotels.it starhotels.com